

DISTRICT OF COLUMBIA GOVERNMENT
 OFFICE OF THE SURVEYOR

Washington, D.C., February 9, 2017

Plat for Building Permit of SQUARE 886 LOT 35

Scale: 1 inch = 20 feet Recorded in Book 38 Page 108

Receipt No. 17-02571

Furnished to: MARIAH RIPPE

Surveyor, D.C.

By: A.S.

All work must be done strictly in accordance herewith an approved plans. Approved plans shall be kept on the site until completion of the construction. No inspection will be made without approved plans on site. The approval does not prevent a field inspection from ordering corrections to meet codes when issues are noted during inspections.

I hereby certify that all existing improvements shown thereon, are completely dimensioned, and are correctly platted; that all proposed buildings or construction, or parts thereof, including covered porches, are correctly dimensioned and platted and agree with plans accompanying the application; that the foundation plans as shown hereon is drawn, and dimensioned accurately to the same scale as the property lines shown on this plat; and that by reason of the proposed improvements to be erected as shown hereon the size of any adjoining Lot or premises is not decreased to an area less than is required by the Zoning Regulations for light and ventilation; and it is further certified that all Lot divisions or combinations pending at the Office of Tax & Revenue are correctly depicted, and it is further certified and agreed that accessible parking area where required by the Zoning Regulations will be reserved in accordance with the Zoning Regulations, and that this area has been correctly drawn and dimensioned hereon. It is further agreed that the elevation of the accessible parking area with respect to the Highway Department approved curb and alley grade will not result in a rate of grade along centerline of driveway at any point on private property in excess of 20% for single-family dwellings or flats, or in excess of 12% at any point for other buildings. (The policy of the Highway Department permits a maximum driveway grade of 12% across the public parking and private restricted property.) Owner/Agent shall indemnify, defend, and hold the District, its officers, employees and agents harmless from and against any and all losses, costs, claims, damages, liabilities, and causes of action (including reasonable attorneys' fees and court costs) arising out of death of or injury to any person or damage to any property occurring on or adjacent to the Property and directly or indirectly caused by any acts done thereon or any acts or omissions of Owner/Agent; provided however, that the foregoing indemnity shall not apply to any losses, costs, claims, damages, liabilities, and causes of action due solely to the gross negligence or willful misconduct of District or its officers, employees or agents. It is the policy of the Zoning Office that a Building Plat is valid for six (6) months from the date of issuance.

Date: 03.31.17

(Signature of owner or his authorized agent)

NOTE: Data shown for Assessment and Taxation Lots or Parcels are in accordance with the records of the Department of Finance and Revenue, Assessment Administration, and do not necessarily agree with deed description.

LA - 2331.60 X .6 = 1398.96 SF
 SECTION A - 20 X 31.38 = 627.60
 SECTION B - 5 X 23.25 = 116.25
 SECTION C - 20 X 32.5 = 650
 TOTAL - 1393.85/2331.60 = 60%

RF-1

DCRA/OFFICE OF THE ZONING
 ADMINISTRATOR/COMPLIES
 WITH REQUIREMENTS OF
 DC ZONING REGULATIONS (11DCMR)

3/31/17

7th STREET, N.E.

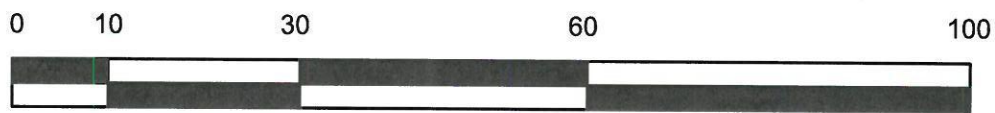
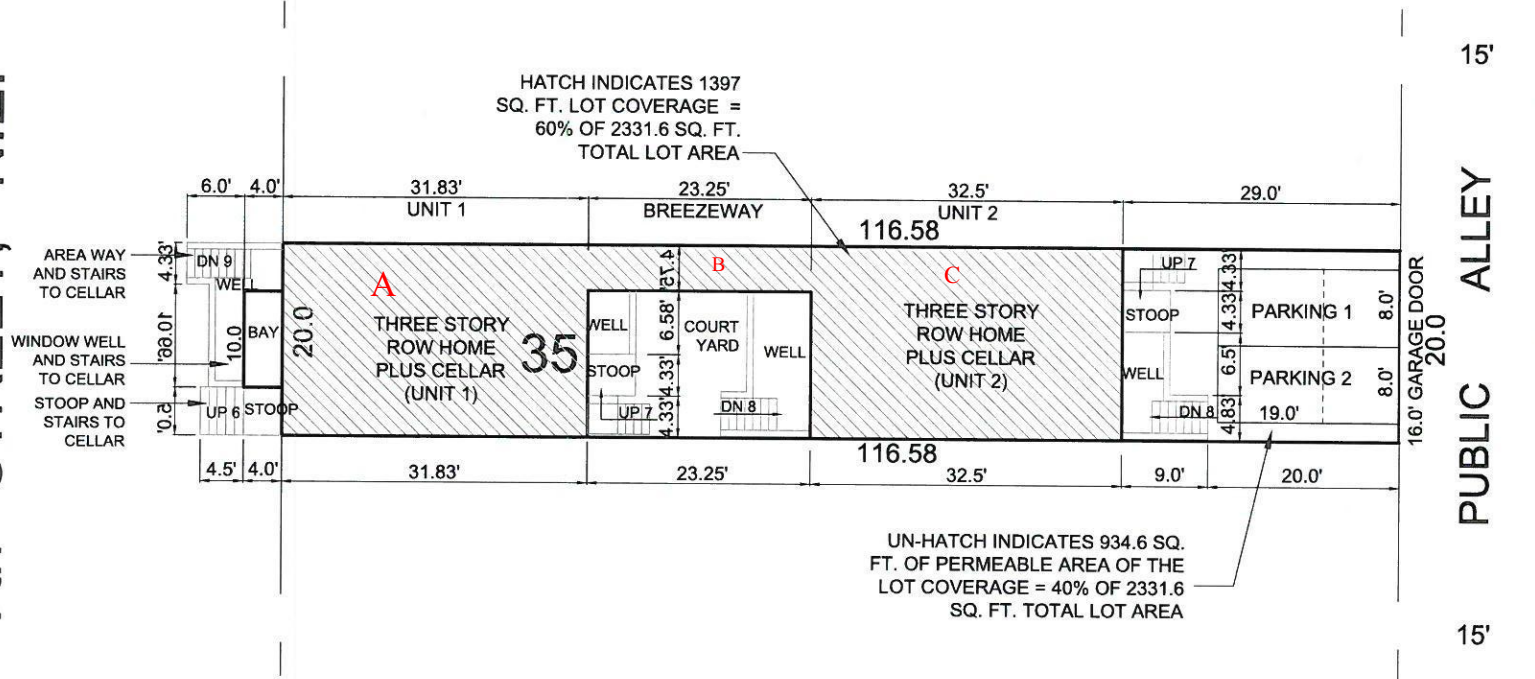

SCALE: 1:20